

# DALIAN YINGYU CO.,LTD.

## V RING CATEGORY

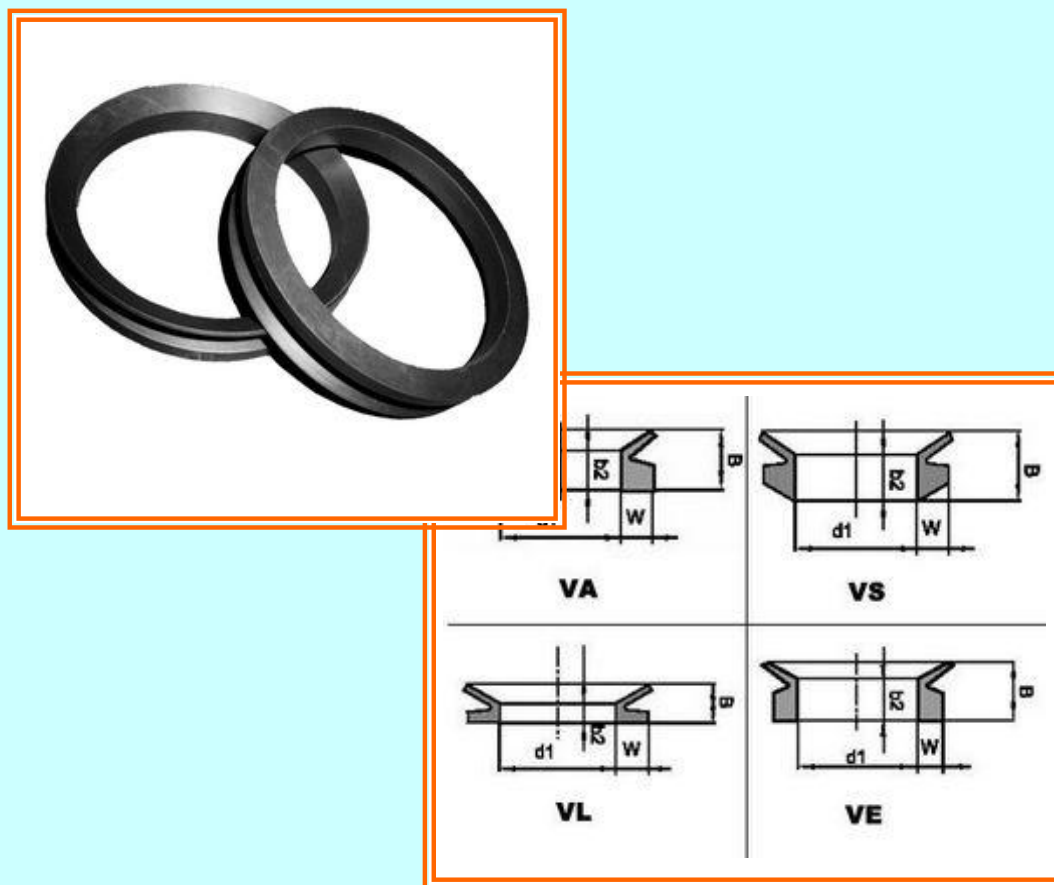

<http://www.dlyingyu.com>

[info@dlyingyu.com](mailto:info@dlyingyu.com)

tel: +86-411-82821900

fax: +86-411-82821980

### V RING

### VA TYPE

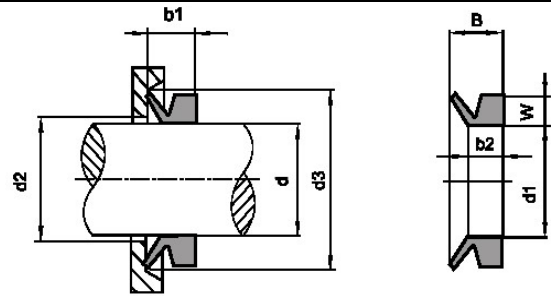

code	product dimension				installation dimension			
	d1	w	B	b2	d	d2	d3	b1
VA-003	2,5	1,5	3,0	2,1	2,7-3,4	d+1	d+4	2,5±0,3
VA-004	3,2	2,0	3,7	2,4	3,5-4,4	d+1	d+6	3,0±0,4
VA-005	4,0	2,0	3,7	2,4	4,5-5,4	d+1	d+6	3,0±0,4
VA-006	5,0	2,0	3,7	2,4	5,5-6,4	d+1	d+6	3,0±0,4
VA-007	6,0	2,0	3,7	2,4	6,5-7,5	d+1	d+6	3,0±0,4
VA-008	7,0	2,0	3,7	2,4	8,0-9,0	d+1	d+6	3,0±0,4
VA-010	9,0	3,0	5,5	3,4	9,5-11,0	d+2	d+9	4,5±0,6
VA-012	10,5	3,0	5,5	3,4	11,5-12,0	d+2	d+9	4,5±0,6
VA-014	12,5	3,0	5,5	3,4	13,5-15,0	d+2	d+9	4,5±0,6
VA-016	14,0	3,0	5,5	3,4	15,5-17,0	d+2	d+9	4,5±0,6
VA-018	16,0	3,0	5,5	3,4	17,5-18,5	d+2	d+9	4,5±0,6
VA-020	18,0	4,0	7,5	4,7	19,0-20,5	d+2	d+12	6,0±0,8
VA-022	20,0	4,0	7,5	4,7	21,0-23,5	d+2	d+12	6,0±0,8
VA-025	22,0	4,0	7,5	4,7	24,0-26,5	d+2	d+12	6,0±0,8
VA-028	25,0	4,0	7,5	4,7	27,0-28,5	d+2	d+12	6,0±0,8
VA-030	27,0	4,0	7,5	4,7	29,0-30,5	d+3	d+12	6,0±0,8
VA-032	29,0	4,0	7,5	4,7	31,0-32,5	d+3	d+12	6,0±0,8
VA-035	31,0	4,0	7,5	4,7	33,0-35,5	d+3	d+12	6,0±0,8
VA-038	34,0	4,0	7,5	4,7	36,0-37,5	d+3	d+12	6,0±0,8
VA-040	36,0	5,0	9,0	5,5	38,0-42,0	d+3	d+15	7,0±1,0
VA-045	40,0	5,0	9,0	5,5	43,0-47,0	d+3	d+15	7,0±1,0
VA-050	45,0	5,0	9,0	5,5	48,0-52,0	d+3	d+15	7,0±1,0
VA-055	49,0	5,0	9,0	5,5	53,0-57,0	d+3	d+15	7,0±1,0
VA-060	54,0	5,0	9,0	5,5	58,0-62,0	d+3	d+15	7,0±1,0
VA-065	58,0	5,0	9,0	5,5	63,0-67,0	d+3	d+15	7,0±1,0
VA-070	63,0	6,0	11,0	6,8	68,0-72,0	d+4	d+18	9,0±1,2
VA-075	67,0	6,0	11,0	6,8	73,0-77,0	d+4	d+18	9,0±1,2
VA-080	72,0	6,0	11,0	6,8	78,0-82,0	d+4	d+18	9,0±1,2
VA-085	76,0	6,0	11,0	6,8	83,0-87,0	d+4	d+18	9,0±1,2
VA-090	81,0	6,0	11,0	6,8	88,0-92,0	d+4	d+18	9,0±1,2
VA-095	85,0	6,0	11,0	6,8	93,0-97,0	d+4	d+18	9,0±1,2
VA-100	90,0	6,0	11,0	6,8	98,0-104,0	d+4	d+18	9,0±1,2
VA-110	99,0	7,0	12,8	7,9	105,0-114,0	d+4	d+21	10,5±1,5

### V RING

### VA TYPE

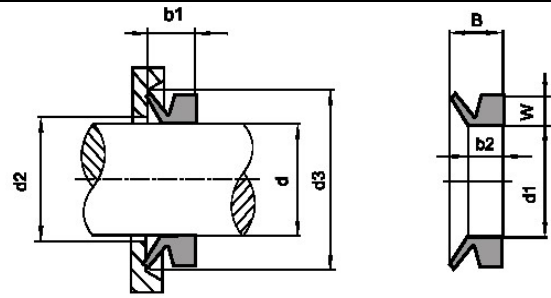

code	product dimension				installation dimension			
	d1	w	B	b2	d	d2	d3	b1
VA-120	108,0	7,0	12,8	7,9	115,0-124,0	d+4	d+21	10,5±1,5
VA-130	117,0	7,0	12,8	7,9	125,0-134,0	d+4	d+21	10,5±1,5
VA-140	126,0	7,0	12,8	7,9	135,0-144,0	d+4	d+21	10,5±1,5
VA-150	135,0	7,0	12,8	7,9	145,0-154,0	d+4	d+21	10,5±1,5
VA-160	144,0	8,0	14,5	9,0	155,0-164,0	d+5	d+24	12,0±1,8
VA-170	153,0	8,0	14,5	9,0	165,0-174,0	d+5	d+24	12,0±1,8
VA-180	162,0	8,0	14,5	9,0	175,0-184,0	d+5	d+24	12,0±1,8
VA-190	171,0	8,0	14,5	9,0	185,0-194,0	d+5	d+24	12,0±1,8
VA-199	180,0	8,0	14,5	9,0	195,0-189,0	d+5	d+24	12,0±1,8
VA-200	180,0	15,0	25,0	14,3	190,0-209,0	d+10	d+45	20,0±4,0
VA-220	198,0	15,0	25,0	14,3	210,0-234,0	d+10	d+45	20,0±4,0
VA-250	225,0	15,0	25,0	14,3	235,0-264,0	d+10	d+45	20,0±4,0
VA-275	247,0	15,0	25,0	14,3	265,0-289,0	d+10	d+45	20,0±4,0
VA-300	270,0	15,0	25,0	14,3	290,0-309,0	d+10	d+45	20,0±4,0
VA-325	292,0	15,0	25,0	14,3	310,0-334,0	d+10	d+45	20,0±4,0
VA-350	315,0	15,0	25,0	14,3	335,0-364,0	d+10	d+45	20,0±4,0
VA-375	337,0	15,0	25,0	14,3	365,0-389,0	d+10	d+45	20,0±4,0
VA-400	360,0	15,0	25,0	14,3	390,0-429,0	d+10	d+45	20,0±4,0
VA-450	405,0	15,0	25,0	14,3	430,0-479,0	d+10	d+45	20,0±4,0
VA-500	450,0	15,0	25,0	14,3	480,0-529,0	d+10	d+45	20,0±4,0
VA-550	495,0	15,0	25,0	14,3	530,0-579,0	d+10	d+45	20,0±4,0
VA-600	540,0	15,0	25,0	14,3	580,0-629,0	d+10	d+45	20,0±4,0
VA-650	600,0	15,0	25,0	14,3	630,0-664,0	d+10	d+45	20,0±4,0
VA-700	630,0	15,0	25,0	14,3	665,0-704,0	d+10	d+45	20,0±4,0
VA-725	670,0	15,0	25,0	14,3	705,0-744,0	d+10	d+45	20,0±4,0
VA-750	705,0	15,0	25,0	14,3	745,0-784,0	d+10	d+45	20,0±4,0
VA-800	745,0	15,0	25,0	14,3	785,0-829,0	d+10	d+45	20,0±4,0
VA-850	785,0	15,0	25,0	14,3	830,0-874,0	d+10	d+45	20,0±4,0
VA-900	825,0	15,0	25,0	14,3	875,0-919,0	d+10	d+45	20,0±4,0
VA-950	865,0	15,0	25,0	14,3	920,0-964,0	d+10	d+45	20,0±4,0
VA-1000	910,0	15,0	25,0	14,3	965,0-1010,0	d+10	d+45	20,0±4,0
VA-1050	955,0	15,0	25,0	14,3	1015,0-1060,0	d+10	d+45	20,0±4,0
VA-1100	1000,0	15,0	25,0	14,3	1065,0-1110,0	d+10	d+45	20,0±4,0

### V RING

### VA TYPE

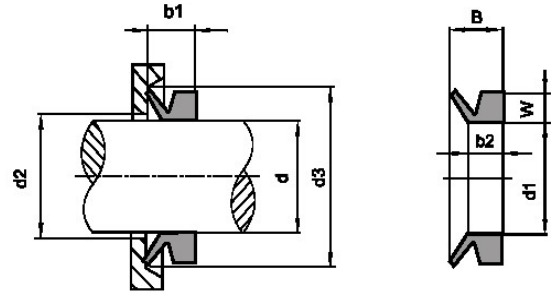

code	product dimension				installation dimension			
	d1	w	B	b2	d	d2	d3	b1
VA-1150	1045,0	15,0	25,0	14,3	1115,0-1160,0	d+10	d+45	20,0±4,0
VA-1200	1090,0	15,0	25,0	14,3	1165,0-1210,0	d+10	d+45	20,0±4,0
VA-1250	1135,0	15,0	25,0	14,3	1215,0-1260,0	d+10	d+45	20,0±4,0
VA-1300	1180,0	15,0	25,0	14,3	1270,0-1310,0	d+10	d+45	20,0±4,0
VA-1350	1225,0	15,0	25,0	14,3	1320,0-1360,0	d+10	d+45	20,0±4,0
VA-1400	1270,0	15,0	25,0	14,3	1370,0-1410,0	d+10	d+45	20,0±4,0
VA-1450	1315,0	15,0	25,0	14,3	1420,0-1460,0	d+10	d+45	20,0±4,0
VA-1500	1360,0	15,0	25,0	14,3	1470,0-1510,0	d+10	d+45	20,0±4,0
VA-1550	1405,0	15,0	25,0	14,3	1520,0-1560,0	d+10	d+45	20,0±4,0
VA-1600	1450,0	15,0	25,0	14,3	1570,0-1610,0	d+10	d+45	20,0±4,0
VA-1650	1495,0	15,0	25,0	14,3	1620,0-1660,0	d+10	d+45	20,0±4,0
VA-1700	1540,0	15,0	25,0	14,3	1670,0-1710,0	d+10	d+45	20,0±4,0
VA-1750	1585,0	15,0	25,0	14,3	1720,0-1760,0	d+10	d+45	20,0±4,0
VA-1800	1630,0	15,0	25,0	14,3	1770,0-1810,0	d+10	d+45	20,0±4,0
VA-1850	1675,0	15,0	25,0	14,3	1820,0-1860,0	d+10	d+45	20,0±4,0
VA-1900	1720,0	15,0	25,0	14,3	1870,0-1910,0	d+10	d+45	20,0±4,0
VA-1950	1765,0	15,0	25,0	14,3	1920,0-1960,0	d+10	d+45	20,0±4,0
VA-2000	1810,0	15,0	25,0	14,3	1970,0-2010,0	d+10	d+45	20,0±4,0

### V RING

### VS TYPE

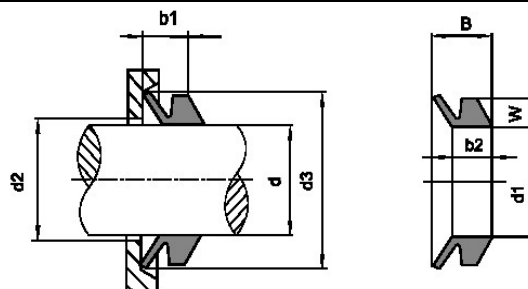

code	product dimension				installation dimension			
	d1	w	B	b2	d	d2	d3	b1
VS-005	4,0	2,0	5,2	3,9	4,5-5,4	d+1	d+6	4,5±0,4
VS-006	5,0	2,0	5,2	3,9	5,5-6,4	d+1	d+6	4,5±0,4
VS-007	6,0	2,0	5,2	3,9	6,5-7,5	d+1	d+6	4,5±0,4
VS-008	7,0	2,0	5,2	3,9	8,0-9,0	d+1	d+6	4,5±0,4
VS-010	9,0	3,0	7,7	5,6	9,5-11,0	d+2	d+9	6,7±0,6
VS-012	10,5	3,0	7,7	5,6	11,5-13,0	d+2	d+9	6,7±0,6
VS-014	12,5	3,0	7,7	5,6	13,5-15,0	d+2	d+9	6,7±0,6
VS-016	14,0	3,0	7,7	5,6	15,5-17,0	d+2	d+9	6,7±0,6
VS-018	16,0	3,0	7,7	5,6	17,5-18,5	d+2	d+9	6,7±0,6
VS-020	18,0	4,0	10,5	7,9	19,0-20,5	d+2	d+12	9,0±0,8
VS-022	20,0	4,0	10,5	7,9	21,0-23,5	d+2	d+12	9,0±0,8
VS-025	22,0	4,0	10,5	7,9	24,0-26,5	d+2	d+12	9,0±0,8
VS-028	25,0	4,0	10,5	7,9	27,0-28,5	d+3	d+12	9,0±0,8
VS-030	27,0	4,0	10,5	7,9	29,0-30,5	d+3	d+12	9,0±0,8
VS-032	29,0	4,0	10,5	7,9	31,0-32,5	d+3	d+12	9,0±0,8
VS-035	31,0	4,0	10,5	7,9	33,0-35,5	d+3	d+12	9,0±0,8
VS-038	34,0	4,0	10,5	7,9	36,0-37,5	d+3	d+12	9,0±0,8
VS-040	36,0	5,0	13,0	9,5	38,0-42,0	d+3	d+15	11,0±1,0
VS-045	40,0	5,0	13,00	9,5	43,0-47,0	d+3	d+15	11,0±1,0
VS-050	45,0	5,0	13,0	9,5	48,0-52,0	d+3	d+15	11,0±1,0
VS-055	49,0	5,0	13,0	9,5	53,0-57,0	d+3	d+15	11,0±1,0
VS-060	54,0	5,0	13,0	9,5	58,0-62,0	d+3	d+15	11,0±1,0
VS-065	58,0	5,0	13,0	9,5	63,0-67,0	d+3	d+15	11,0±1,0
VS-070	63,0	6,0	15,5	11,3	68,0-72,0	d+4	d+18	13,5±1,2
VS-075	67,0	6,0	15,5	11,3	73,0-77,0	d+4	d+18	13,5±1,2
VS-080	72,0	6,0	15,5	11,3	78,0-82,0	d+4	d+18	13,5±1,2
VS-085	76,0	6,0	15,5	11,3	83,0-87,0	d+4	d+18	13,5±1,2
VS-090	81,0	6,0	15,5	11,3	88,0-92,0	d+4	d+18	13,5±1,2
VS-095	85,0	6,0	15,5	11,3	93,0-97,0	d+4	d+18	13,5±1,2
VS-100	90,0	6,0	15,5	11,3	98,0-104,0	d+4	d+18	13,5±1,2
VS-110	99,0	7,0	18,0	13,1	105,0-114,0	d+4	d+21	15,5±1,5
VS-120	108,0	7,0	18,0	13,1	115,0-124,0	d+4	d+21	15,5±1,5
VS-130	117,0	7,0	18,0	13,1	125,0-134,0	d+4	d+21	15,5±1,5

### V RING

### VS TYPE

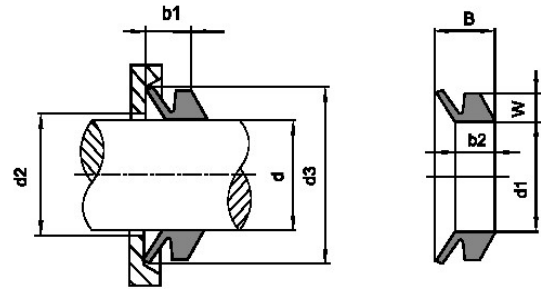

code	product dimension				installation dimension			
	d1	w	B	b2	d	d2	d3	b1
VS-140	126,0	7,0	18,0	13,1	135,0-144,0	d+4	d+21	15,5±1,5
VS-150	135,0	7,0	18,0	13,1	145,0-154,0	d+4	d+21	15,5±1,5
VS-160	144,0	8,0	20,5	15,0	155,0-164,0	d+5	d+24	18,0±1,8
VS-170	153,0	8,0	20,5	15,0	165,0-174,0	d+5	d+24	18,0±1,8
VS-180	162,0	8,0	20,5	15,0	175,0-184,0	d+5	d+24	18,0±1,8
VS-190	171,0	8,0	20,5	15,0	185,0-194,0	d+5	d+24	18,0±1,8
VS-200	180,0	8,0	20,5	15,0	195,0-210,0	d+5	d+24	18,0±1,8

### V RING

### VL TYPE

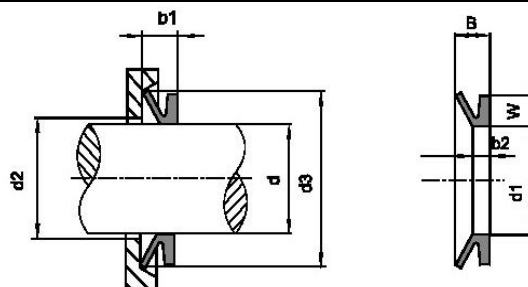

code	product dimension				installation dimension			
	d1	w	B	b2	d	d2	d3	b1
VL-120	108,0	6,5	10,5	6,0	115-120	d+5	d+20	8,0±1,5
VL-130	117,0	6,5	10,5	6,0	125-130	d+5	d+20	8,0±1,5
VL-140	126,0	6,5	10,5	6,0	135-140	d+5	d+20	8,0±1,5
VL-150	135,0	6,5	10,5	6,0	145-150	d+5	d+20	8,0±1,5
VL-160	144,0	6,5	10,5	6,0	155-160	d+5	d+20	8,0±1,5
VL-170	153,0	6,5	10,5	6,0	165-170	d+5	d+20	8,0±1,5
VL-180	162,0	6,5	10,5	6,0	175-180	d+5	d+20	8,0±1,5
VL-190	171,0	6,5	10,5	6,0	185-190	d+5	d+20	8,0±1,5
VL-200	182,0	6,5	10,5	6,0	195-205	d+5	d+20	8,0±1,5
VL-220	198,0	6,5	10,5	6,0	210-230	d+5	d+20	8,0±1,5
VL-250	225,0	6,5	10,5	6,0	233-255	d+5	d+20	8,0±1,5
VL-275	247,0	6,5	10,5	6,0	260-280	d+5	d+20	8,0±1,5
VL-300	270,0	6,5	10,5	6,0	285-305	d+5	d+20	8,0±1,5
VL-325	292,0	6,5	10,5	6,0	310-330	d+5	d+20	8,0±1,5
VL-350	315,0	6,5	10,5	6,0	335-360	d+5	d+20	8,0±1,5
VL-375	337,0	6,5	10,5	6,0	365-380	d+5	d+20	8,0±1,5
VL-400	360,0	6,5	10,5	6,0	385-405	d+5	d+20	8,0±1,5
VL-425	382,0	6,5	10,5	6,0	410-435	d+5	d+20	8,0±1,5
VL-450	405,0	6,5	10,5	6,0	440-475	d+5	d+20	8,0±1,5
VL-500	450,0	6,5	10,5	6,0	480-525	d+5	d+20	8,0±1,5
VL-550	485,0	6,5	10,5	6,0	530-575	d+5	d+20	8,0±1,5
VL-600	540,0	6,5	10,5	6,0	580-630	d+5	d+20	8,0±1,5

### V RING

#### VE,VB TYPE

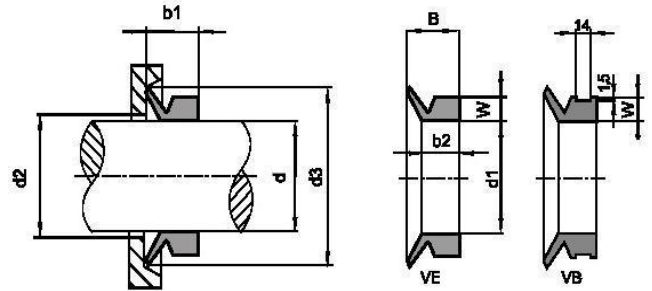

code	product dimension				installation dimension				
	d1	w	B	b2	d	d2	d3	b1	
VB-300	294,0	21,0	65,0	32,5	300,0	d+24	d+115	50,0±12	
VB-305	299,0	21,0	65,0	32,5	305,0	d+24	d+115	50,0±12	
VE-310	304,0	30,0	65,0	32,5	310,0	d+24	d+115	50,0±12	
VB-315	309,0	21,0	65,0	32,5	315,0	d+24	d+115	50,0±12	
VE-320	314,0	30,0	65,0	32,5	320,0	d+24	d+115	50,0±12	
VB-325	319,0	21,0	65,0	32,5	325,0	d+24	d+115	50,0±12	
VB-330	323,0	21,0	65,0	32,5	330,0	d+24	d+115	50,0±12	
VB-335	328,0	21,0	65,0	32,5	335,0	d+24	d+115	50,0±12	
VB-340	333,0	21,0	65,0	32,5	340,0	d+24	d+115	50,0±12	
VB-345	338,0	21,0	65,0	32,5	345,0	d+24	d+115	50,0±12	
VB-350	343,0	21,0	65,0	32,5	350,0	d+24	d+115	50,0±12	
VB-355	347,0	21,0	65,0	32,5	355,0	d+24	d+115	50,0±12	
VB-360	352,0	21,0	65,0	32,5	360,0	d+24	d+115	50,0±12	
VB-365	357,0	21,0	65,0	32,5	365,0	d+24	d+115	50,0±12	
VB-375	367,0	21,0	65,0	32,5	375,0	d+24	d+115	50,0±12	
VE-380	371,0	30,0	65,0	32,5	380,0	d+24	d+115	50,0±12	
VB-385	376,0	21,0	65,0	32,5	385,0	d+24	d+115	50,0±12	
VE-390	381,0	30,0	65,0	32,5	390,0	d+24	d+115	50,0±12	
VB-395	386,0	21,0	65,0	32,5	395,0	d+24	d+115	50,0±12	
VB-400	391,0	21,0	65,0	32,5	400,0	d+24	d+115	50,0±12	
VB-405	396,0	21,0	65,0	32,5	405,0	d+24	d+115	50,0±12	
VB-410	401,0	21,0	65,0	32,5	410,0	d+24	d+115	50,0±12	
VB-415	405,0	21,0	65,0	32,5	415,0	d+24	d+115	50,0±12	
VB-420	410,0	21,0	65,0	32,5	420,0	d+24	d+115	50,0±12	
VB-425	415,0	21,0	65,0	32,5	425,0	d+24	d+115	50,0±12	
VB-430	420,0	21,0	65,0	32,5	430,0	d+24	d+115	50,0±12	
VB-435	425,0	21,0	65,0	32,5	435,0	d+24	d+115	50,0±12	
VB-440	429,0	21,0	65,0	32,5	440,0	d+24	d+115	50,0±12	
VB-445	434,0	21,0	65,0	32,5	445,0	d+24	d+115	50,0±12	
VB-450	439,0	21,0	65,0	32,5	450,0	d+24	d+115	50,0±12	
VB-455	444,0	21,0	65,0	32,5	455,0	d+24	d+115	50,0±12	
VE-460	448,0	30,0	65,0	32,5	460,0	d+24	d+115	50,0±12	
VB-465	453,0	21,0	65,0	32,5	465,0	d+24	d+115	50,0±12	



### V RING

### VE,VB TYPE

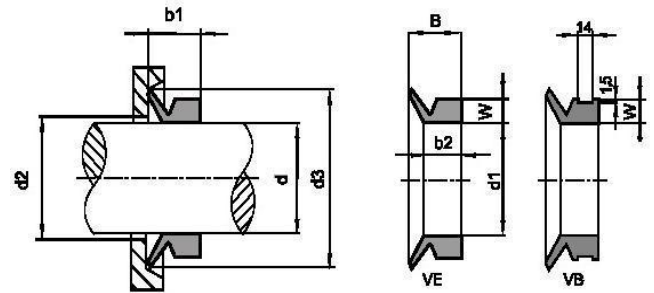

code	product dimension				installation dimension				
	d1	w	B	b2	d	d2	d3	b1	
VB-470	458,0	21,0	65,0	32,5	470,0	d+24	d+115	50,0±12	
VB-475	463,0	21,0	65,0	32,5	475,0	d+24	d+115	50,0±12	
VB-480	468,0	21,0	65,0	32,5	480,0	d+24	d+115	50,0±12	
VE-485	473,0	30,0	65,0	32,5	485,0	d+24	d+115	50,0±12	
VB-490	478,0	21,0	65,0	32,5	490,0	d+24	d+115	50,0±12	
VB-495	483,0	21,0	65,0	32,5	495,0	d+24	d+115	50,0±12	
VB-500	488,0	21,0	65,0	32,5	500,0	d+24	d+115	50,0±12	
VB-505	493,0	21,0	65,0	32,5	505,0	d+24	d+115	50,0±12	
VB-510	497,0	21,0	65,0	32,5	510,0	d+24	d+115	50,0±12	
VE-515	502,0	30,0	65,0	32,5	515,0	d+24	d+115	50,0±12	
VB-520	507,0	21,0	65,0	32,5	520,0	d+24	d+115	50,0±12	
VB-525	512,0	21,0	65,0	32,5	525,0	d+24	d+115	50,0±12	
VB-530	517,0	21,0	65,0	32,5	530,0	d+24	d+115	50,0±12	
VB-535	521,0	21,0	65,0	32,5	535,0	d+24	d+115	50,0±12	
VB-540	526,0	21,0	65,0	32,5	540,0	d+24	d+115	50,0±12	
VB-545	531,0	21,0	65,0	32,5	545,0	d+24	d+115	50,0±12	
VB-550	536,0	21,0	65,0	32,5	550,0	d+24	d+115	50,0±12	
VB-555	541,0	21,0	65,0	32,5	555,0	d+24	d+115	50,0±12	
VB-560	546,0	21,0	65,0	32,5	560,0	d+24	d+115	50,0±12	
VB-565	550,0	21,0	65,0	32,5	565,0	d+24	d+115	50,0±12	
VB-570	555,0	21,0	65,0	32,5	570,0	d+24	d+115	50,0±12	
VB-575	560,0	21,0	65,0	32,5	575,0	d+24	d+115	50,0±12	
VE-580	565,0	30,0	65,0	32,5	580,0	d+24	d+115	50,0±12	
VB-585	570,0	21,0	65,0	32,5	585,0	d+24	d+115	50,0±12	
VB-590	575,0	21,0	65,0	32,5	590,0	d+24	d+115	50,0±12	
VE-600	582,0	30,0	65,0	32,5	600,0	d+24	d+115	50,0±12	
VB-610	592,0	21,0	65,0	32,5	610,0	d+24	d+115	50,0±12	
VB-620	602,0	21,0	65,0	32,5	620,0	d+24	d+115	50,0±12	
VB-630	612,0	21,0	65,0	32,5	630,0	d+24	d+115	50,0±12	
VB-640	621,0	21,0	65,0	32,5	640,0	d+24	d+115	50,0±12	
VB-650	631,0	21,0	65,0	32,5	650,0	d+24	d+115	50,0±12	
VE-660	640,0	30,0	65,0	32,5	660,0	d+24	d+115	50,0±12	
VB-670	650,0	21,0	65,0	32,5	670,0	d+24	d+115	50,0±12	

### V RING

#### VE,VB TYPE

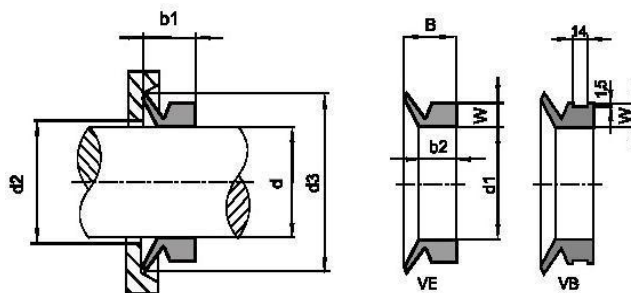

code	product dimension				installation dimension			
	d1	w	B	b2	d	d2	d3	b1
VB-680	660,0	21,0	65,0	32,5	680,0	d+24	d+115	50,0±12
VE-690	670,0	30,0	65,0	32,5	690,0	d+24	d+115	50,0±12
VB-700	680,0	21,0	65,0	32,5	700,0	d+24	d+115	50,0±12
VB-710	689,0	21,0	65,0	32,5	710,0	d+24	d+115	50,0±12
VB-720	699,0	21,0	65,0	32,5	720,0	d+24	d+115	50,0±12
VB-730	709,0	21,0	65,0	32,5	730,0	d+24	d+115	50,0±12
VE-740	718,0	30,0	65,0	32,5	740,0	d+24	d+115	50,0±12
VB-750	728,0	21,0	65,0	32,5	750,0	d+24	d+115	50,0±12
VB-760	735,0	21,0	65,0	32,5	760,0	d+24	d+115	50,0±12
VB-770	743,0	21,0	65,0	32,5	770,0	d+24	d+115	50,0±12
VB-780	751,0	21,0	65,0	32,5	780,0	d+24	d+115	50,0±12
VB-790	759,0	21,0	65,0	32,5	790,0	d+24	d+115	50,0±12
VB-800	768,0	21,0	65,0	32,5	800,0	d+24	d+115	50,0±12
VB-810	777,0	21,0	65,0	32,5	810,0	d+24	d+115	50,0±12
VE-820	786,0	30,0	65,0	32,5	820,0	d+24	d+115	50,0±12
VB-830	796,0	21,0	65,0	32,5	830,0	d+24	d+115	50,0±12
VB-840	805,0	21,0	65,0	32,5	840,0	d+24	d+115	50,0±12
VB-850	814,0	21,0	65,0	32,5	850,0	d+24	d+115	50,0±12
VB-860	824,0	21,0	65,0	32,5	860,0	d+24	d+115	50,0±12
VB-870	833,0	21,0	65,0	32,5	870,0	d+24	d+115	50,0±12
VB-880	843,0	21,0	65,0	32,5	880,0	d+24	d+115	50,0±12
VB-890	853,0	21,0	65,0	32,5	890,0	d+24	d+115	50,0±12
VE-900	871,0	30,0	65,0	32,5	900,0	d+24	d+115	50,0±12
VB-920	880,0	21,0	65,0	32,5	920,0	d+24	d+115	50,0±12
VB-930	890,0	21,0	65,0	32,5	930,0	d+24	d+115	50,0±12
VB-940	900,0	21,0	65,0	32,5	940,0	d+24	d+115	50,0±12
VB-950	911,0	21,0	65,0	32,5	950,0	d+24	d+115	50,0±12
VB-960	921,0	21,0	65,0	32,5	960,0	d+24	d+115	50,0±12
VB-970	932,0	21,0	65,0	32,5	970,0	d+24	d+115	50,0±12
VB-980	942,0	21,0	65,0	32,5	980,0	d+24	d+115	50,0±12
VB-990	953,0	21,0	65,0	32,5	990,0	d+24	d+115	50,0±12
VE-1000	963,0	30,0	65,0	32,5	1000,0	d+24	d+115	50,0±12
VE-1020	973,0	30,0	65,0	32,5	1020,0	d+24	d+115	50,0±12

### V RING

#### VE,VB TYPE

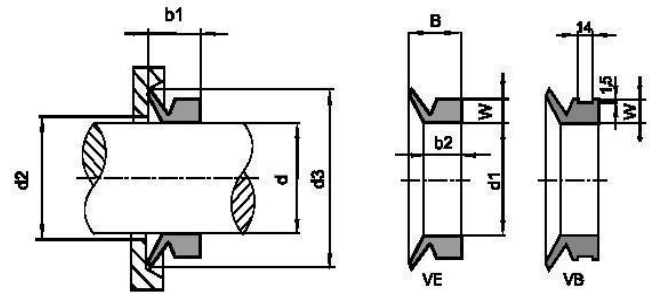

code	product dimension				installation dimension				
	d1	w	B	b2	d	d2	d3	b1	
VB-1040	990,0	21,0	65,0	32,5	1040,0	d+24	d+115	50,0±12	
VB-1060	1008,0	21,0	65,0	32,5	1060,0	d+24	d+115	50,0±12	
VB-1080	1027,0	21,0	65,0	32,5	1080,0	d+24	d+115	50,0±12	
VB-1100	1045,0	21,0	65,0	32,5	1100,0	d+24	d+115	50,0±12	
VB-1120	1065,0	21,0	65,0	32,5	1120,0	d+24	d+115	50,0±12	
VB-1140	1084,0	21,0	65,0	32,5	1140,0	d+24	d+115	50,0±12	
VB-1160	1103,0	21,0	65,0	32,5	1160,0	d+24	d+115	50,0±12	
VB-1180	1121,0	21,0	65,0	32,5	1180,0	d+24	d+115	50,0±12	
VE-1200	1139,0	30,0	65,0	32,5	1200,0	d+24	d+115	50,0±12	
VB-1220	1157,0	21,0	65,0	32,5	1220,0	d+24	d+115	50,0±12	
VE-1240	1176,0	30,0	65,0	32,5	1240,0	d+24	d+115	50,0±12	
VB-1260	1195,0	21,0	65,0	32,5	1260,0	d+24	d+115	50,0±12	
VE-1280	1218,0	30,0	65,0	32,5	1280,0	d+24	d+115	50,0±12	
VB-1300	1240,0	21,0	65,0	32,5	1300,0	d+24	d+115	50,0±12	
VE-1325	1259,0	30,0	65,0	32,5	1325,0	d+24	d+115	50,0±12	
VB-1350	1281,0	21,0	65,0	32,5	1350,0	d+24	d+115	50,0±12	
VB-1375	1305,0	21,0	65,0	32,5	1375,0	d+24	d+115	50,0±12	
VB-1400	1328,0	21,0	65,0	32,5	1400,0	d+24	d+115	50,0±12	
VB-1425	1350,0	21,0	65,0	32,5	1425,0	d+24	d+115	50,0±12	
VB-1450	1374,0	21,0	65,0	32,5	1450,0	d+24	d+115	50,0±12	
VB-1475	1397,0	21,0	65,0	32,5	1475,0	d+24	d+115	50,0±12	
VB-1500	1419,0	21,0	65,0	32,5	1500,0	d+24	d+115	50,0±12	
VB-1525	1443,0	21,0	65,0	32,5	1525,0	d+24	d+115	50,0±12	
VB-1550	1467,0	21,0	65,0	32,5	1550,0	d+24	d+115	50,0±12	
VB-1575	1495,0	21,0	65,0	32,5	1575,0	d+24	d+115	50,0±12	
VB-1600	1524,0	21,0	65,0	32,5	1600,0	d+24	d+115	50,0±12	
VB-1650	1559,0	21,0	65,0	32,5	1650,0	d+24	d+115	50,0±12	
VB-1700	1596,0	21,0	65,0	32,5	1700,0	d+24	d+115	50,0±12	
VB-1750	1632,0	21,0	65,0	32,5	1750,0	d+24	d+115	50,0±12	
VB-1800	1671,0	21,0	65,0	32,5	1800,0	d+24	d+115	50,0±12	
VB-1850	1714,0	21,0	65,0	32,5	1850,0	d+24	d+115	50,0±12	
VB-1900	1753,0	21,0	65,0	32,5	1900,0	d+24	d+115	50,0±12	
VB-1950	1794,0	21,0	65,0	32,5	1950,0	d+24	d+115	50,0±12	
VB-2000	1844,0	21,0	65,0	32,5	2000,0	d+24	d+115	50,0±12	